

ROTARY TOOL WorkCenter

MILESCRAFT
Always the Better Idea.

Rockford, IL 61109 • Patent Pending • www.milescraft.com

	GMC	BLACK & DECKER RT	EINHELL	AXMINSTER	DREMEL 398, 395, 285, 275
	✓	✓	✓	✓	✓

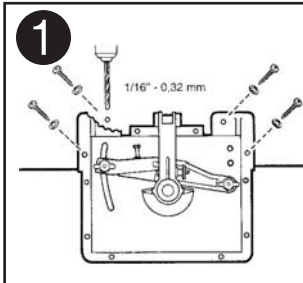

(GB) WORK CENTER

Model 1098

SAFETY WARNING: Wear eye protection and dust mask.

- 1 Mounting router table
- 2 Mounting the tool
- 3 Depth adjustment
- 4 Use wrench
- 5 Outside/inside routing
- 6 Using support 'A'
- 7 Working direction by using pilot bits
- 8 Expanding work surface

(D) WORK CENTER

Modell 1098

Sicherheitshinweis: Setzen Sie eine Schutzbrille und eine Staubschutzmaske auf.

- 1 Montieren des Oberfräsentisches
- 2 Montieren des Werkzeuges
- 3 Tiefeneinstellung
- 4 Gebrauch des Schlüssels
- 5 Fräsen von Oberflächen außen/innen
- 6 Anwendung des Anschlagers
- 7 Einrichtung von "Rundspitzfräsern"
- 8 Vergrößern der Arbeitsfläche

(F) WORK CENTER

Modèle 1098

Avertissement de sécurité : Porter des lunettes de sécurité et un masque anti-poussière.

- 1 Montage table de défonceuse
- 2 Montage de l'outil
- 3 Jauge de profondeur
- 4 Utilisez la clé
- 5 Fraiser des surfaces extérieures/intérieures
- 6 Utilisation du guide 'A'
- 7 Sens d'utilisation avec fraises avec guide
- 8 Elargir la table

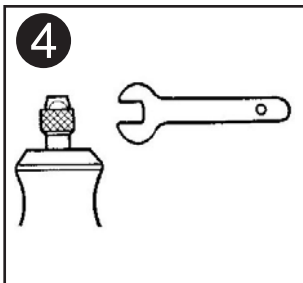
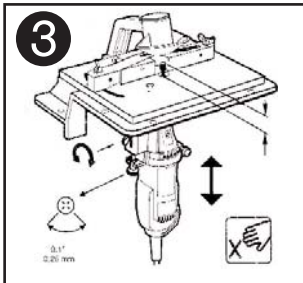
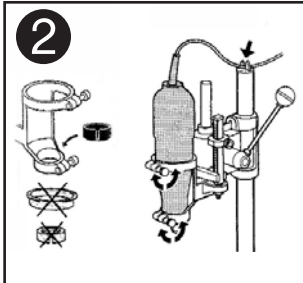

(NL) WORK CENTER

Model 1098

Veiligheidswaarschuwing: Draag een oogbescherming en een stofmasker.

- 1 Montage freestafel
- 2 Monteren machine
- 3 Diepte-instelling
- 4 Gebruik sleutel
- 5 Binnen-/buitenwerks frezen
- 6 Gebruik van geleider 'A'
- 7 Werkrichting bij frezen met geleide-pen
- 8 Vergroten werkoppervlak

(S) WORK CENTER

1098-modellen

WARNING! Använd skyddsglasögon och andningsmask.

- 1 Montering av fräsbord
- 2 Montering av verktyg
- 3 Djupinställning
- 4 Använd en nickel
- 5 Inner-/ytterfräsning
- 6 Med underlag 'A'
- 7 Arbetsriktning med styrbitar
- 8 Att utöka arbetsytan

(N) WORK CENTER

Modell 1098

Sikkerhetsvarsel: Bruk vernebriller og støvmaske.

- 1 Montering av fresebord
- 2 Monteringsverktøy
- 3 Dybdejustering
- 4 Bruk skrunøkkel
- 5 Utvendig/innvendig fresing
- 6 Bruke støtte 'A'
- 7 Freseretning ved bruk av styretapper
- 8 Utvide arbeidsflaten

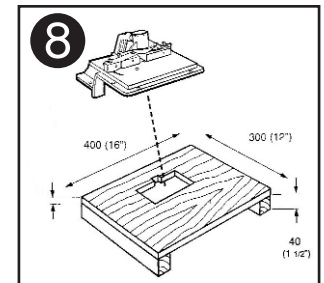
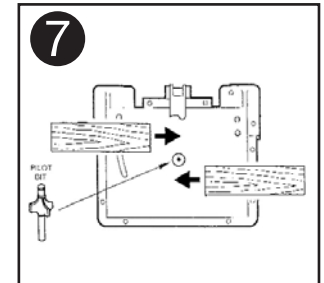
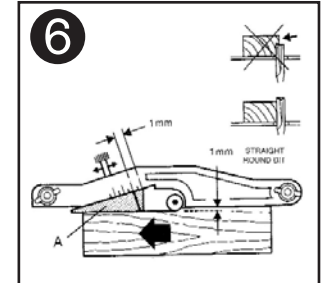
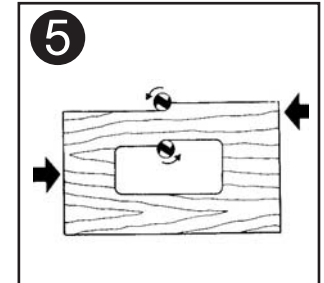

ROTARY TOOL WorkCenter

MILESCRAFT
Always the Better Idea.

Rockford, IL 61109 • Patent Pending • www.milescraft.com

	GMC	BLACK & DECKER RT	EINHELL	AXMINSTER	DREMEL 398, 395, 285, 275
	✓	✓	✓	✓	✓

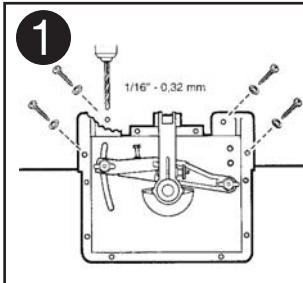

(FI) WORK CENTER

Malli 1097

Varoitus: Käytä silmä- ja hengityssuojusta.

- 1 Jyrsinpöydän asentaminen
- 2 Työkalun asentaminen
- 3 Syvyyden säätäminen
- 4 Käytä avainta
- 5 Sisä-/ulkopuolinen jyrsintä
- 6 'A'-tuen käyttäminen
- 7 Työskentelysuunta ohjausterää käytettäessä
- 8 Työskentelyalan suurentaminen

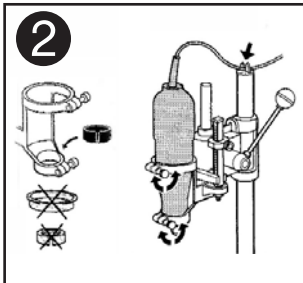

(DK) WORK CENTER

Model 1097

Sikkerhedsadvarsel: Vi anbefaler brug af beskyttelsesbriller og støvmaske.

- 1 Montering af fræsebord
- 2 Montering af værktøj
- 3 Dybdejustering
- 4 Brug skruenøgle
- 5 Udvendig/indvendig fræsning
- 6 Brug underlag 'A'
- 7 Arbejdsretning for styrebits
- 8 Udvidelse af arbejdsområdet

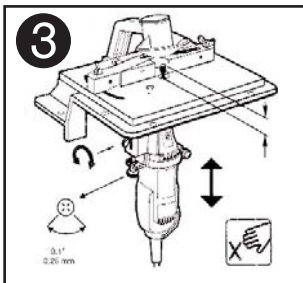

(E) WORK CENTER

Modelo 1097

Advertencia de seguridad: use protección ocular y mascarilla contra el polvo.

- 1 Montaje mesa buriladora
- 2 Montaje de la herramienta
- 3 Ajuste de profundidad
- 4 Utilice llave
- 5 Fresar de superficies exteriors/interiors
- 6 Forma de empleo de la guía 'A'
- 7 Dirección de trabajo usando guías
- 8 Agrandar la mesa

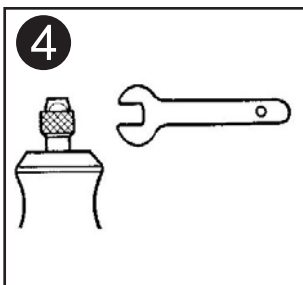

(I) WORK CENTER

Modello 1097

Avvertenza sulla sicurezza: indossare occhiali protettivi e maschere antipolvere.

- 1 Montaggio della tavola di fresatura
- 2 Installazione dell'utensile
- 3 Regolazione della profondità
- 4 Utilizzare la chiave
- 5 Fresatura di superfici esterne/interne
- 6 Utilizzo della guida 'A'
- 7 Direzione di lavorazione con uso di frees guida
- 8 Estensione della superficie di lavoro

(P) WORK CENTER

Modelo 1097

Advertência de segurança: Utilize proteção ocular e máscara contra poeiras.

- 1 Montagem de mesa da debastadora
- 2 Montagem da ferramenta
- 3 Regulação de profundidade
- 4 Utilize a chave de porcas
- 5 Desbaste de superfícies exteriors/interiors
- 6 Forma de utilização da guia 'A'
- 7 Direção de trabalho utilizando brocas com guias
- 8 Expandir a superfície de trabalho

(GR) WORK CENTER

Μοντέλο 1098

Προειδοποίηση ασφαλείας: Γυαλιά προστασίας και προσωπίδα με φίλτρο σκόνης.

- 1 Προσδεση τραπέζας φρεζαρισματος
- 2 Προσδεση εργαλειου
- 3 Ρυθμιση βαθους
- 4 Χρηση κλειδιου (εργαλειου)
- 5 Εξωτερικο/Εσωτερικο φρεζαρισμα
- 6 Χρηση υποστηριξης 'A'
- 7 Κατευθυνη εργασις χρησιμοποιωντας πιλοτικο τρυπανι
- 8 Διευρυνση επιφανειας εργασις

